

- Tube Fitting (Double Ferrule)-
Tube To Male Pipe Thread

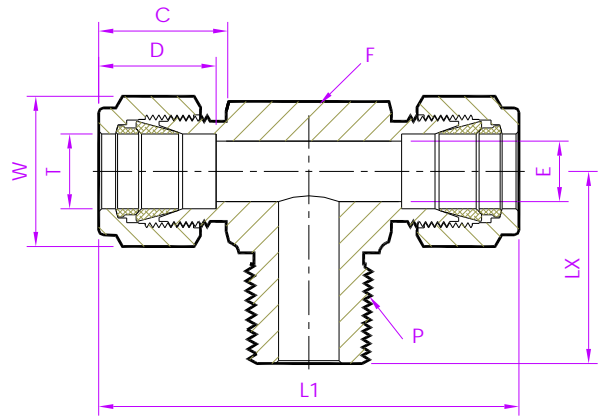

Male Branch Tee

Fractional Tube x NPT (M)

Tubefit Part No.	Equivalent Part No. Type 1	Equivalent Part No. Type 2	TUBE OD Ø T	NPT Male Pipe Size P	ØE	D	C	L1	LX	Body Hex F	Nut Hex W
Dimensions in Inches											
2 - MBTD - 2N	- 200 - 3 - 2TTM	2MBT2N	1/8	1/8	0.09	0.50	0.60	1.86	0.70	1/2	7/16
2 - MBTD - 4N	- 200 - 3 - 4TTM	2MBT4N		1/4	0.09			1.94	0.92	9/16	
3 - MBTD - 2N	- 300 - 3 - 2TTM	3MBT2N	3/16	1/8	0.12	0.54	0.63	1.92	0.70	1/2	1/2
4 - MBTD - 2N	- 400 - 3 - 2TTM	4MBT2N	1/4	1/8	0.19	0.60	0.70	2.12	0.74	9/16	9/16
4 - MBTD - 4N	- 400 - 3 - 4TTM	4MBT4N		1/4	0.19			2.12	0.92	9/16	
5 - MBTD - 2N	- 500 - 3 - 2TTM	5MBT2N	5/16	1/8	0.19	0.64	0.73	2.34	0.82	5/8	5/8
5 - MBTD - 4N	- 500 - 3 - 4TTM	5MBT4N		1/4	0.25			2.34	1.01	5/8	
6 - MBTD - 4N	- 600 - 3 - 4TTM	6MBT4N	3/8	1/4	0.28	0.66	0.76	2.40	1.00	5/8	11/16
6 - MBTD - 6N	- 600 - 3 - 6TTM	6MBT6N		3/8	0.28			2.62	1.11	13/16	
8 - MBTD - 6N	- 810 - 3 - 6TTM	8MBT6N	1/2	3/8	0.38	0.90	0.86	2.84	1.11	13/16	7/8
8 - MBTD - 8N	- 810 - 3 - 8TTM	8MBT8N		1/2	0.41			2.84	1.30	7/8	
10 - MBTD - 8N	- 1010 - 3 - 8TTM	10MBT8N	5/8	1/2	0.47	0.96	0.86	3.06	1.41	15/16	1
12 - MBTD - 12N	- 1210 - 3 - 12TTM	12MBT12N	3/4	3/4	0.62	0.96	0.86	3.14	1.45	1.1/16	1.1/8
14 - MBTD - 12N	- 1410 - 3 - 12TTM	14MBT12N	7/8	3/4	0.62	1.02	0.86	3.52	1.50	1.3/8	1.1/4
16 - MBTD - 12N	- 1610 - 3 - 12TTM	16MBT12N	1	3/4	0.62	1.23	1.04	3.88	1.66	1.3/8	1.1/2
16 - MBTD - 16N	- 1610 - 3 - 16TTM	16MBT16N		1	0.88			3.88	1.84	1.3/8	

NOTE: 1)The E Dimension is the minimum opening & fittings of this group may be back drilling to larger ID at pipe thread or straight thread end.
2)Dimension L1, C, D is shown in the finger-tight position. 3)Dimensions are for reference only and are subject to change 4)NPT thread as per ANSI B 1.20.1.
- ALL PART NUMBERS ARE PROPRIETARY OF THEIR RESPECTIVE OWNERS. -